

Welcome to Court Lane Junior Academy





Deputy Head
Mrs K Reynolds



Headteacher
Mrs J Ramshaw



SEND Leader
Mrs E Carter



These are the
teachers in Year 3



Miss E Kelly
Year 3 Lead
PEACOCK CLASS



Miss R Brain
ADAMS CLASS



Miss E Clark
HOY CLASS



Miss P Mangat
FARAH CLASS



Miss A Quade

Other adults who will work with us



Mrs L Culliford
Teaching Assistant



Mrs K Leunig
Teaching Assistant



Miss M Oosterwijk
Teaching Assistant



Mrs S Robinson
Teaching Assistant



Mrs J Rogers
TeachingAssistant



Miss M Swann
Teaching Assistant



Mrs D Tulk
Teaching Assistant



Mrs R Wallace
Teaching Assistant



Mr J Leigh
Teaching Assistant

Cover Supervisors



Miss H Bell
Cover Supervisor



Miss J Mitchell
Cover Supervisor

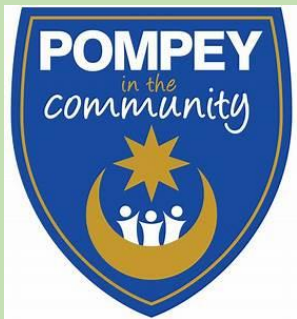

We also have staff to cover the teachers when they are out of class. They could be teaching art, dance and drama or Outdoor Education. The coaches from Pompey in the Community also come in and coach us in PE skills.

Other people that can help me



Mrs S Wait
Pastoral Manager



Mrs R Terrett
Pastoral Assistant



Mrs S Foster
Emotional Literacy
Support Assistant



Mrs C Colvin
Emotional Literacy
Support Assistant

A map of our school

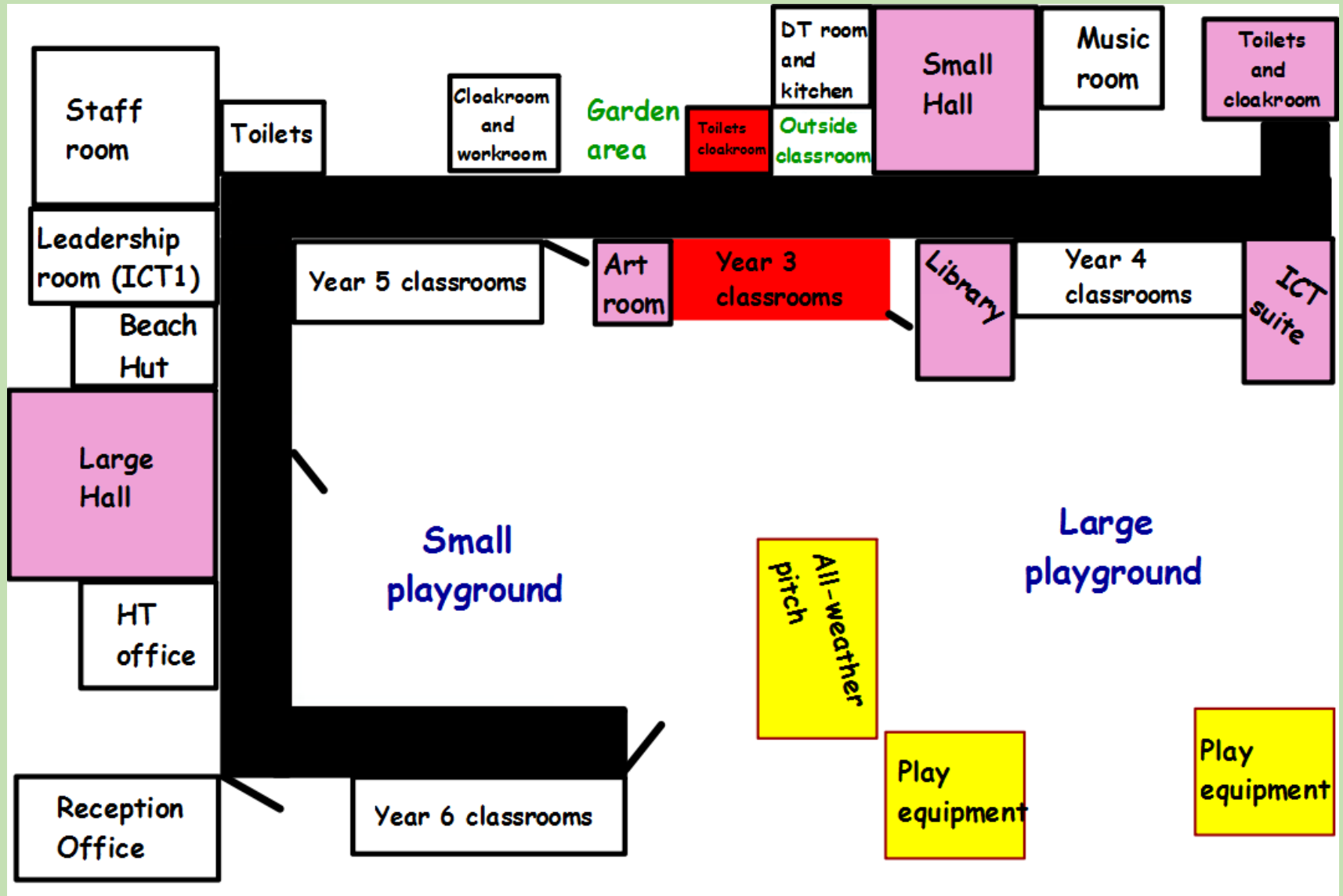

The Beach Hut - Pastoral Room



This is where you may come and meet Mrs Terrett, Mrs Colvin or Mrs Foster if you have been asked to work with them.

Mrs Wait, Mrs Terrett, Mrs Colvin and Mrs Foster are in here to help.



The Year 3 Corridor

Miss Brain
ADAMS

Miss Clark
HOY

Miss Quade/Miss Mangat
FARAH

Miss Kelly
PEACOCK



Year 3 outside

Miss Kelly
PEACOCK

Miss Quade/Miss Mangat
FARAH

Miss Clark
HOY

Miss Brain
ADAMS



Outside the Year 3 Classrooms

This is where you will come into class everyday - first thing in the morning, after break and after lunch. This is also the door you will leave from at the end of the day

Year 3 Shared Areas



The cloakroom

In this area we keep our coats and PE bags.

It is quite a small area so it is important to keep our coats and bags tidy.



The toilets

Here you can see one side with toilets and hand basins. As this is a shared space it is important that we keep this area tidy and clean too.

Other areas around school



Art Room

In here we have lots of art resources for classes to use and space for classes to do whole class projects



ICT Suite

Each class has a slot each week to come in and use the computers as a class.



Music Room

This room and the Small Hall are used for class and individual music lessons .

Other areas around school

These three areas are at the back of the school. We only go into these areas when we are with an adult. We might go into the garden as part of Gardening Club with Mrs Beer. The wildlife areas and the pond we will explore during Outdoor Education sessions.



The pond area

Wildlife area



Garden



In the playground



The Large Hall

We have assemblies and PE lessons in here. The stage is used for shows and the Year 6 End of Year production.

The Large Hall is also used for lunchtimes.

This is also where the PTA hold film nights and discos.



The Small Hall



The Small Hall is also used for assemblies and PE. But is mainly used for music, drama and dance sessions. It is often used for an exciting activity to a topic, sports demonstrations or as an area to work in groups.



In the library



Mrs C Gibbons
Librarian

The library is where we come to choose and return our Accelerated Reader scheme book and the book we our reading for pleasure. There are lots of books in the library that can help children feel calm and relaxed.

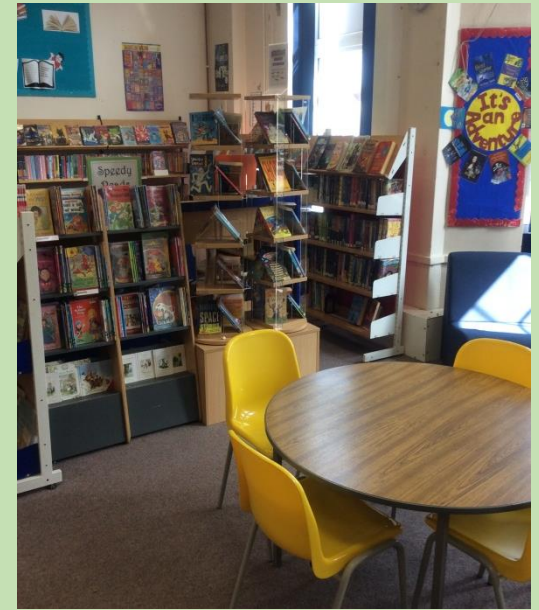

The library is open all day but opens Mondays and Wednesdays from 8.15am and after school Thursdays until 3.50pm.



Front Office



First Aid room



This is right at the front of the school. You only need to come into school this way if you are late or if you are returning after an appointment. You only come to the First Aid Room if an adult has sent you or you need medicine whilst in school.



Things to remember



If I feel worried or frustrated it will be best to:

1. Tell an adult - your class teacher, one of the teaching assistants or an adult on the playground.
2. Find a friend to talk to or help you find the help you need.

If I need help around the school, I can:

1. Ask a friend
2. Ask another child
3. Ask any adult to help me

If I need help with my work I could:

1. Think about what the teacher said.
2. Check the white board to remind me.
3. Check what everyone else is doing.
4. Use resources on my table and in the classroom to help me.
5. Put my hand up and ask.



We are looking forward to
seeing you in September!

