

Welcome back to



Court Lane Junior Academy



Head Teacher
Mrs L Flitton



Deputy Head
Mrs K Reynolds



SEND Leader
Mrs E Carter



These are the teachers in Year 4

Miss Kelly
Year 4 Leader
Class



Mrs Ray
Mary Rose Class



Miss Brain
Mary Rose Class



Miss Nolan
Victory Class

Miss Hunt
Warrior Class

Other adults who will work with us



Miss Jones
Teaching Assistant



Mrs Mulligan
Teaching Assistant



Mrs Rogers
Teaching Assistant



Miss Payne
Year 4 ELSA



Miss Man
Teaching Assistant



Mrs Cox
Teaching Assistant



Mrs Lovibond
EHCA

Other people that can help me



Mrs S Wait
Pastoral Manager



Miss R Terrett
SEND Assistant



Mrs C Colvin
Year 6 ELSA



Mrs S Robinson
Year 5 ELSA



Miss L Harper
Year 3 ELSA

A map of our school

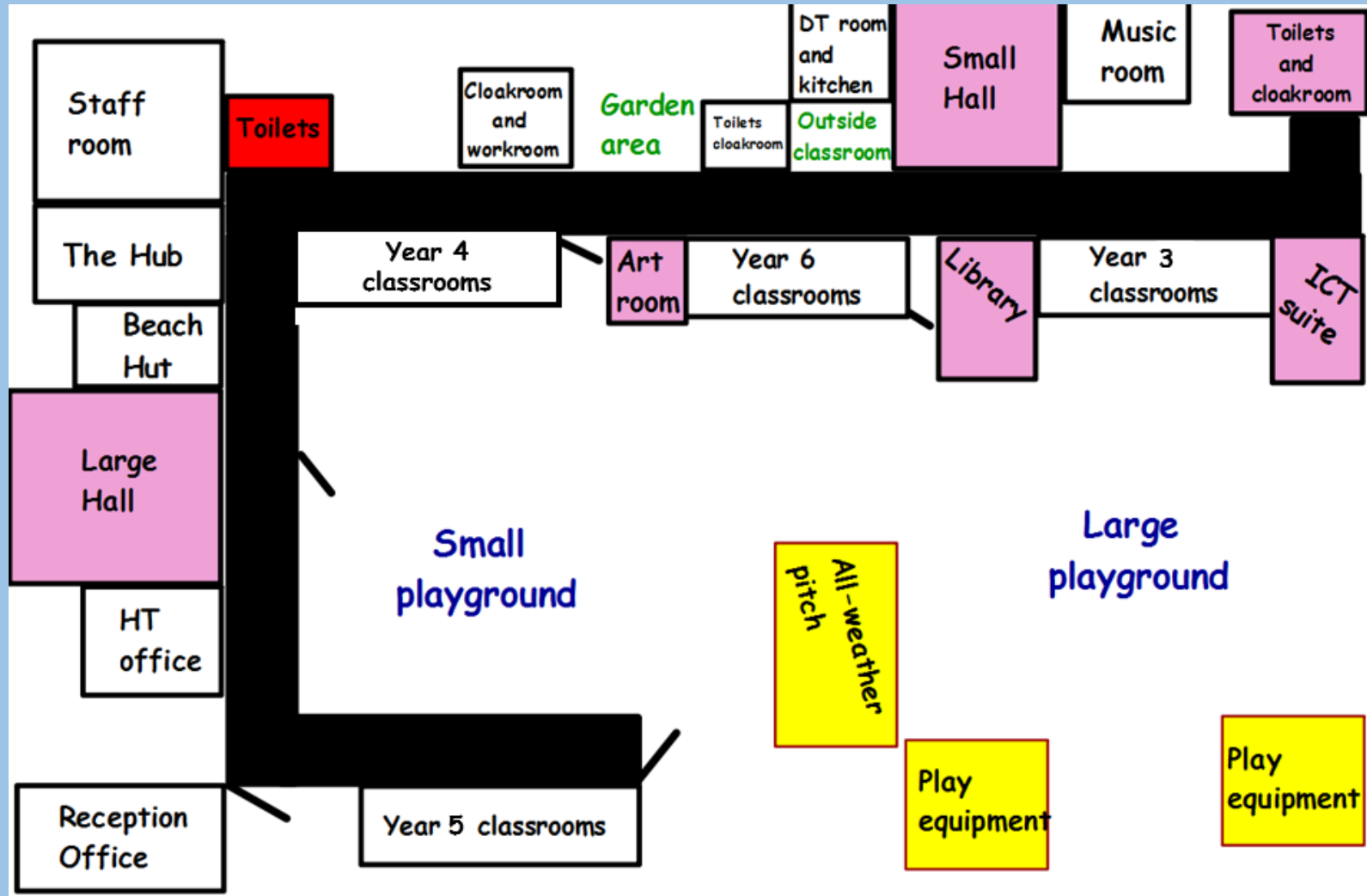

The Beach Hut and The Hub (ELSA Room)



Mrs Wait and Mrs Colvin are next door in The Beach Hut. They might ask you to come and talk to them in there.

Miss Terrett, Mrs Robinson and Miss Payne are in here to help. You might be invited to come here and work.



The Year 4 Corridor

Miss Nolan
Victory Class

Mrs Ray & Miss Brain
Mary Rose Class

Miss Hunt
Warrior Class

Miss Kelly
Nelson Class



Year 4 outside

Nelson Class

Warrior Class

Mary Rose Class

Victory Class



Outside the Year 4 Classrooms

This is where you will come into class everyday - first thing in the morning, after break and after lunch. This is also the door you will leave from at the end of the day

Other areas around school



Art Room

In here we have lots of art resources for classes to use and space for classes to do whole class projects.



ICT Suite

Each class has a slot each week to come in and use the computers as a class. We also have I-Pads in our classrooms.



Music Room

This room and the Small Hall are used for class and individual music lessons .

Other areas around school



Garden.

These three areas are at the back of the school. We only go into these areas when we are with an adult. We might go into the garden as part of Gardening Club with Mrs Beer. The wildlife areas and the pond we will explore during Outdoor Education sessions.

Wildlife area.

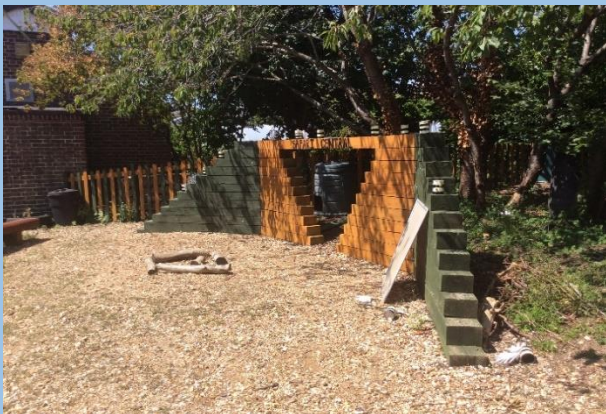

Pond area.



In the playground



Multi-Sports area.



Seating area.



Play Equipment.

The Large Hall

We have assemblies and PE lessons in here. The stage is used for shows and the Year 6 End of Year production.

The Large Hall is also used for school dinners at lunchtime.



The Small Hall



The Small Hall is also used for assemblies and PE. But is mainly used for music, drama and dance sessions.

It is often used for an exciting start to activity or to a topic, for a sports demonstration or as an area to work in groups.



In the library

Although we have a fantastic range of reading books in our classrooms - we also have a brilliant library. We will come here with an adult to change the selection of books in our reading area or to find books linked to our topics. It is a calm and relaxed place. Adults can help you to find the information or the books you need.



Front Office



First Aid room



This is right at the front of the school.
You only need to come into school this way if you are late or if you are returning after an appointment.
You only come to the First Aid Room if an adult has sent you or you need medicine whilst in school.



Things to remember



If I feel worried or frustrated it will be best to:

1. Tell an adult - your class teacher, one of the teaching assistants or an adult on the playground.
2. Find a friend to talk to or help you find the help you need.

If I need help around the school, I can:

1. Ask a friend
2. Ask another child
3. Ask any adult to help me

If I need help with my work I could:

1. Think about what the teacher said.
2. Check the white board to remind me.
3. Check what everyone else is doing.
4. Use resources on my table and in the classroom to help me.
5. Put my hand up and ask.

We are looking forward to



seeing you in September!